

# 120 x 120 x 25 mm

**New !**

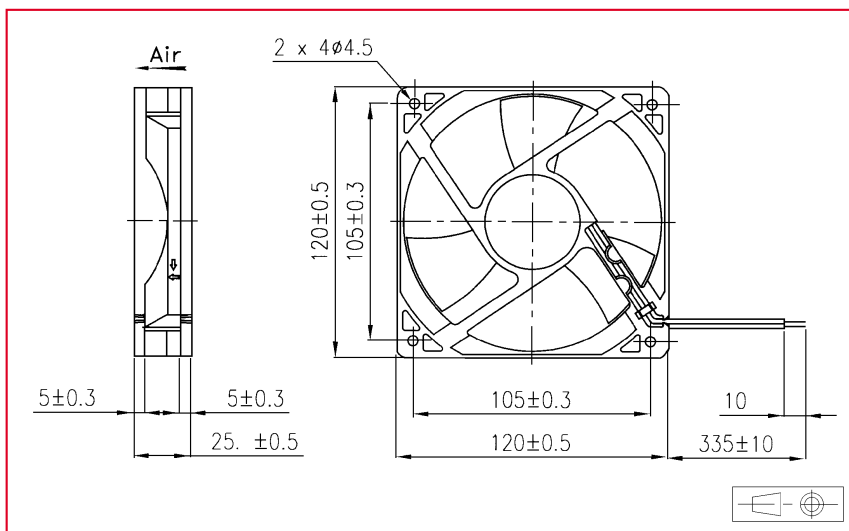

DC  
Axial Fans



### Approvals

See selection guide pages 15 to 26

### Life expectancy

L-10 LIFE AT 40°C:

**80 000 hours**

For more details, see page 14

### Brushless DC Motor

Electrical protection: impedance protected

Housing material: plastic UL 94 VO

Impeller material: plastic UL 94 VO

Weight: 180 g

### Available with:

- speed sensor

- open collector alarm

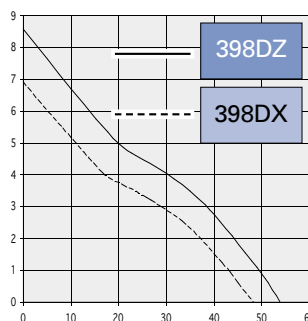
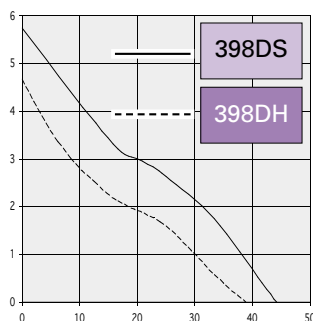
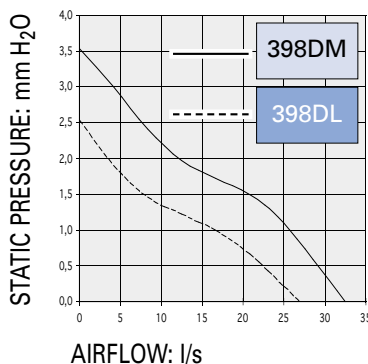

Part number	Nominal voltage	Airflow	Noise level	Nominal speed	Input power	Voltage range	Bearing system		Connection type		Operating temperature	
	V	l/s	dB(A)	RPM	W	V	Ball	Sleeve	Leads	Terminals	Min. °C	Max. °C
398DL1LP11000	12	27,0	31	1950	1,7	(7-13,8)	X		X		- 10	60
398DL2LP11000	24	27,0	31	1950	1,7	(14-27,6)	X		X		- 10	60
398DL4LP11000	48	27,0	31	1950	1,9	(28-56)	X		X		- 10	60
398DM1LP11000	12	32,5	34	2300	2,0	(7-13,8)	X		X		- 10	60
398DM2LP11000	24	32,5	34	2300	2,2	(14-27,6)	X		X		- 10	60
398DM4LP11000	48	32,5	34	2300	2,4	(28-56)	X		X		- 10	60
398DH1LP11000	12	38,8	39	2670	3,2	(7-13,8)	X		X		- 10	60
398DH2LP11000	24	38,8	39	2670	3,4	(14-27,6)	X		X		- 10	60
398DH4LP11000	48	38,8	39	2670	3,4	(28-56)	X		X		- 10	60
398DS1LP11000	12	44,2	42,5	3000	3,6	(7-13,8)	X		X		- 10	60
398DS2LP11000	24	44,2	42,5	3000	3,6	(14-27,6)	X		X		- 10	60
398DS4LP11000	48	44,2	42,5	3000	3,8	(28-56)	X		X		- 10	60
398DX1LP11000	12	48,2	45,5	3300	4,8	(7-13,8)	X		X		- 10	60
398DX2LP11000	24	48,2	45,5	3300	4,8	(14-27,6)	X		X		- 10	60
398DZ1LP11000	12	53,8	48,5	3700	6,0	(7-13,8)	X		X		- 10	60
398DZ2LP11000	24	53,8	48,5	3700	6,0	(14-27,6)	X		X		- 10	60

### Additional versions:

398DX and 398DZ in 48 V

### Accessories:

See pages: 148, 150, 151, 152, 153, 154, 157, and 162

Non contractual document. Specifications are subject to change without prior notice. Pictures for information only. Edition N°2 / 01.