

ø 239,5 x 181 mm

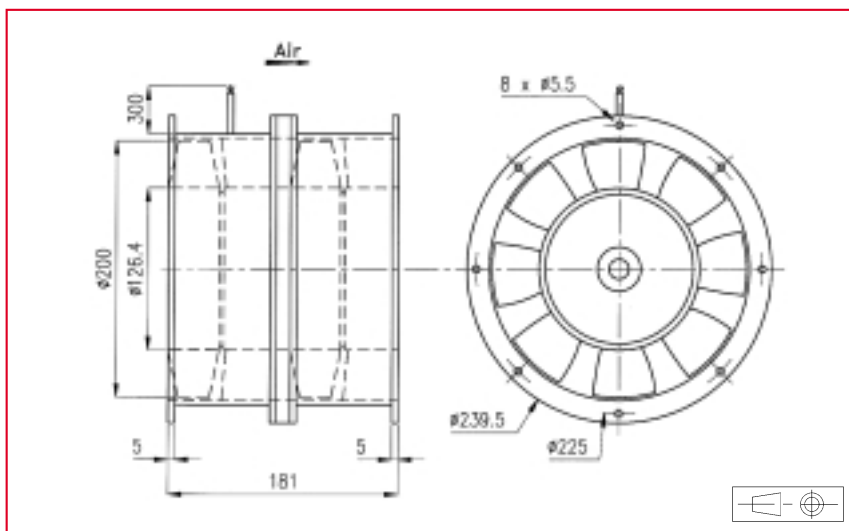

Approvals

See selection guide pages 15 to 26
GAMT 1 listed

Life expectancy

L-10 LIFE AT 40°C:

25 000 hours

For more details, see page 14

AC Motor

Housing material: aluminium

Impeller material: plastic

Weight: 6,95 kg

Bearing system: ball bearings

Available with:

- safety switch
- terminal block

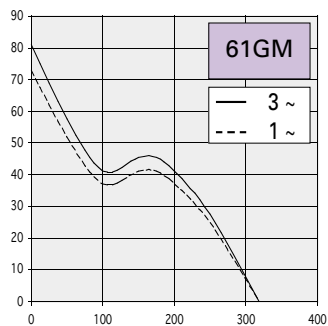
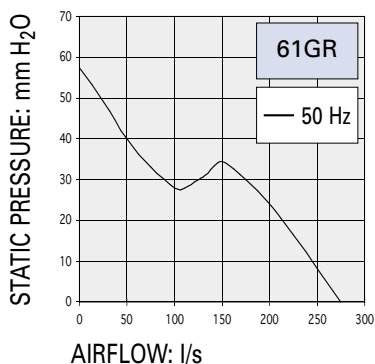

Non contractual document. Specifications are subject to change without prior notice. Pictures for information only. Edition N°2 / 01.

High Performance

Part number	Nominal voltage	Airflow	Noise level	Nominal speed	Frequency	Phases	Capacitor (not included)	Input power	Nominal current	Starting current	Connection type		Operating temperature	
	V	l/s	dB(A)	RPM	Hz						Leads	Terminals	Min. °C	Max. °C
61GR116DC13	220	275	72	2750	50	3		100	400	1750	X		- 10	70
	380	275	72	2750	50	3		100	230	1000	X		- 10	70
	220	275	72	2750	50	1	6,9	105	480	1500	X		- 10	70
	380	275	72	2750	50	1	2,2	105	280	900	X		- 10	70
61GM116DC13	220	318	74	3300	60	3		160	690	2600	X		- 10	70
	380	318	74	3300	60	3		160	400	1500	X		- 10	70
	220	318	74	3300	60	1	10	166	780	2100	X		- 10	70
	380	318	74	3300	60	1	3,2	166	450	1200	X		- 10	70

Additional versions:

Salt spray protected - shock and vibration protected - marine specifications - wide temperature range - other voltages (consult factory)

Accessories:

See pages: 155, 158, 159 and 163